

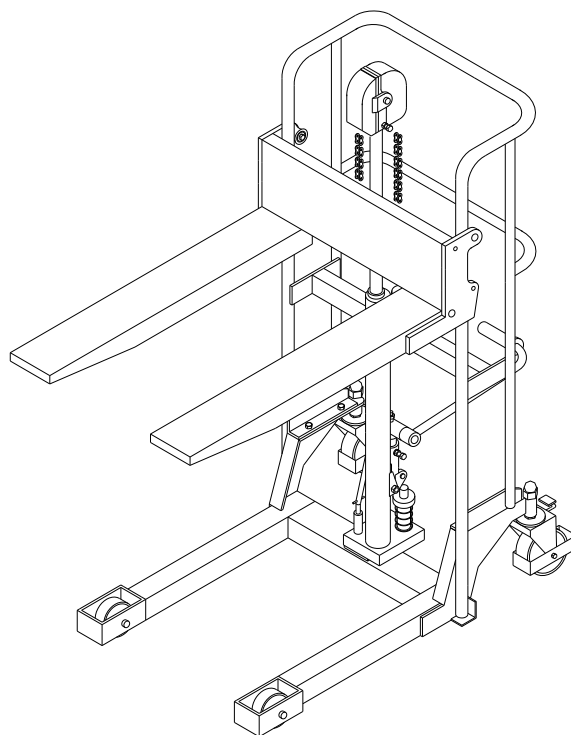

# **HANDSTAPLER PJ**

## **Datenblatt**

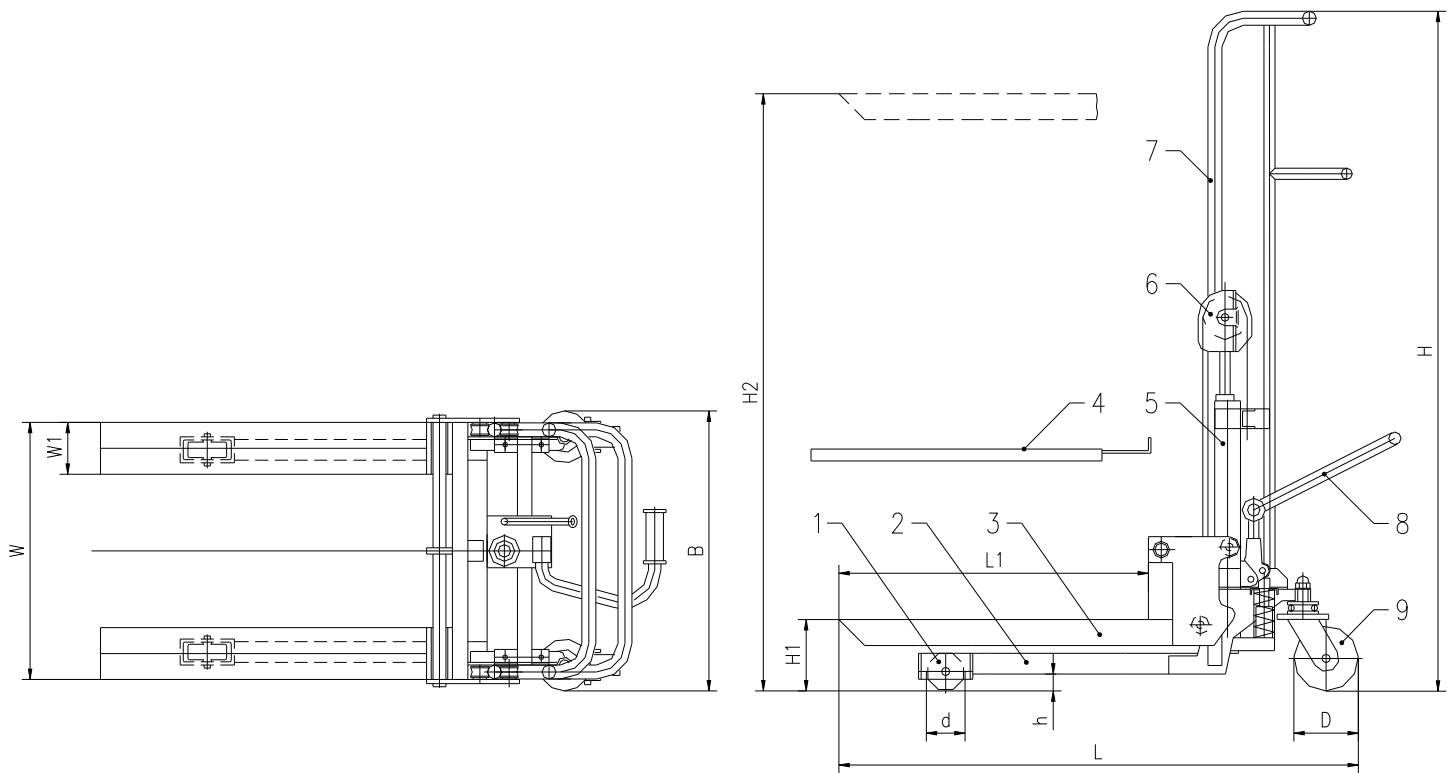



Mod.	H (mm)	H1 (mm)	H2 (mm)	L (mm)	L1 (mm)	W1 (mm)	W (mm)	B (mm)	d (mm)	D (mm)	Tragkraft (kg)	Gewicht (kg)
PJ4085	1120	90	850	1130	650	110	550	580	Ø75	Ø125	400	80
PJ4110	1380	90	1100	1130	650	110	550	580	Ø75	Ø125	400	85
PJ4120	1470	90	1200	1130	650	110	550	580	Ø75	Ø125	400	86
PJ4130	1570	90	1300	1130	650	110	550	580	Ø75	Ø125	400	88
PJ4150	1770	90	1500	1130	650	110	550	580	Ø75	Ø125	400	91
PJ4170	1980	90	1700	1130	650	110	550	580	Ø75	Ø125	400	98

- 1) Vorderrad
- 2) Chassis
- 3) Plattform (Gabeln)
- 4) Arbeitsplattform
- 5) Zylinder Assembly
- 6) Kettenrad
- 7) Slideway Handlauf
- 8) Fußhebel
- 9) Hinterrad